

REFERENCE PLANS:

[illegible]

ABULJENS

[illegible]

INDEX OF SHEETS,

SHEET 1 COVER SHEET
SHEET 2 SUBDIVISION PLAN LOT E-30
SHEET 3 LOT LINE REVISION & SUBDIVISION PLAN LOTS E-31 & 36
SHEET 4 TEST PIT DATA SHEET
SHEET 5 CISTERN DETAIL SHEET



REV.	DATE	DESCRIPTION	C/O	DR	CK
F	01/09/08	NOTE MOVEMENTS SET	MPS	JGL	RHM
G	11/02/07	NOTE C&B ST	MPS	JGL	RHM
E	11/14/07	MURS LOT REASONS	MPS	SCH	RHM
D	10/26/07	UPGRADE NOTES	MPS	MPP	RHM
C	10/12/07	UPDATE LOT NUMBERS & COST	MPS	MPP	RHM
B	9/12/07	REVERSE NOTES, LOTS & SHEET INDEX	MCC	MPP	RHM
A	9/12/07	UPDATE DUTY, STRAPBOOKS, & PLYT MEX	MPP	RHM	RHM
REV.	DATE	DESCRIPTION	C/O	DR	CK



SCRIPTURE FARM

LOT LINE REVISION & SUBDIVISION PLAN

TAX MAP PARCELS E-30, E-31 & E-36

MASON, NEW HAMPSHIRE

AUGUST 1, 2007
LAST REVISED: JANUARY 9, 2008

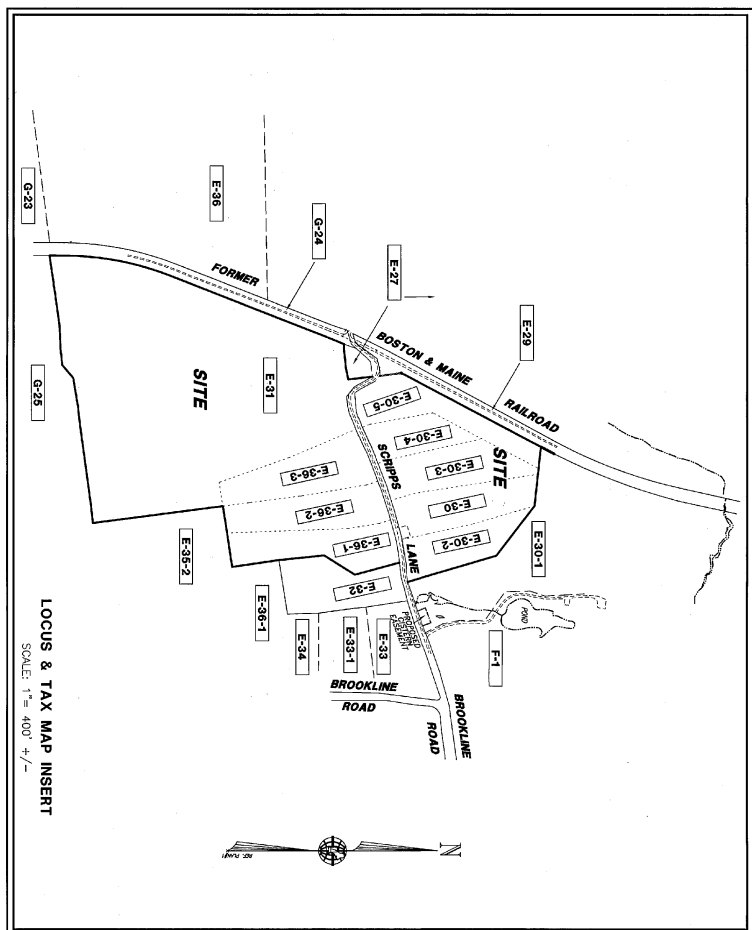

GENERAL CONSTRUCTION NOTES:

1. THE LOCATION OF THE UTILITIES SHOWN ARE APPROXIMATE. IT IS THE RESPONSIBILITY OF THE CONTRACTOR TO LOCATE AND PRESERVE ALL UTILITY SERVICES.
2. THE CONTRACTOR IS RESPONSIBLE FOR CONTACTING AND COORDINATING WITH ALL UTILITY COMPANIES AND JURISDICTIONAL AGENCIES PRIOR TO AND DURING CONSTRUCTION.
3. THE CONTRACTOR SHALL VERIFY ALL DIMENSIONS AND PROPOSED WORK PRIOR TO CONSTRUCTION.

**LAND OF
ROBERT G. LIPIN**

EVELYN F. ELLIS
MASON, NEW HAMPSHIRE 03048

NOTES

1. THE OWNERS OF RECORD OF TAX MAP PARCELS E-50, E-51, E-52, E-53, E-54, E-55, E-56, ROBERT G. LIPIN & EVELYN F. ELIAS - 119 SCOWLES LANE - WILSON, N.J. DEED REFERENCE IS VOL. 3822 PG. 285 DATED JANUARY 24, 1987 AND VOL. 3267 PG. 763, DATED JUNE 24, 1981 IN THE F.I.C.D.
2. THE PURPOSE OF THIS PLAN IS TO SUBDIVIDE TAX MAP PARCELS E-50 AND THE LOTS, REVERSE LOTS E-51, E-52, E-53 AND SUBDIVIDE PARCELS E-54, E-55, E-56 INTO 3 LOTS WHICH RESULTS IN 3 REVERSED EXISTING LOTS AND 6 ADDITIONAL LOTS, AS SHOWN.
3. [E-50] DENOTES TAX MAP PAGE AND PARCEL NUMBER.

5. ZONING

- [illegible]

CERTIFICATION:

DATE: 2-15-06

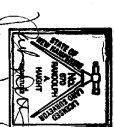

SCRIPTURE FARM
LOT LINE REVISION & SUBDIVISION PLAN
TAX MAP PARCELS E-30, 31 & 36
LAND OF
**ROBERT G. LIPIN
& EVELYN F. ELLIS**
MASON, NEW HAMPSHIRE

PREPARED BY:

**MERIDIAN**

Land Services, Inc.

OFFICE: 31 OLD NASHUA ROAD, 03031
AMHERST, NEW HAMPSHIRE
MAILING ADDRESS: PO BOX 118, WILFORD, NEW HAMPSHIRE 03055-0118
TEL: 603-873-1141 FAX 603-873-1584 MEMO@LANDSERVICES.COM

ENGINEERS - LAND SURVEYORS - SCIENTISTS - LAND PLANNERS

PLAN 35915.1 OF 4
DRAWER 167

Doc # 8065646 Feb 25, 2008 12:29 PM
Plan 35915.1 of 4 DWR167
Register of Deeds, Hillsborough County
C:\d\35915\35915.1.dwg

